



Wellow Lane

Bath, BA2 8JQ

£439,950

A sizeable bungalow located within a quiet corner of Peasedown St. John yet well connected to amenities and public transport links.

No onward sales chain!
Large loft space primed for conversion
Three double bedrooms
Delightful garden
Quiet location
Close to amenities

Viewing

Please contact our Bath Stone Property (MSN) Office on 01761 360144

if you wish to arrange a viewing appointment for this property or require further information.



Floor Plan

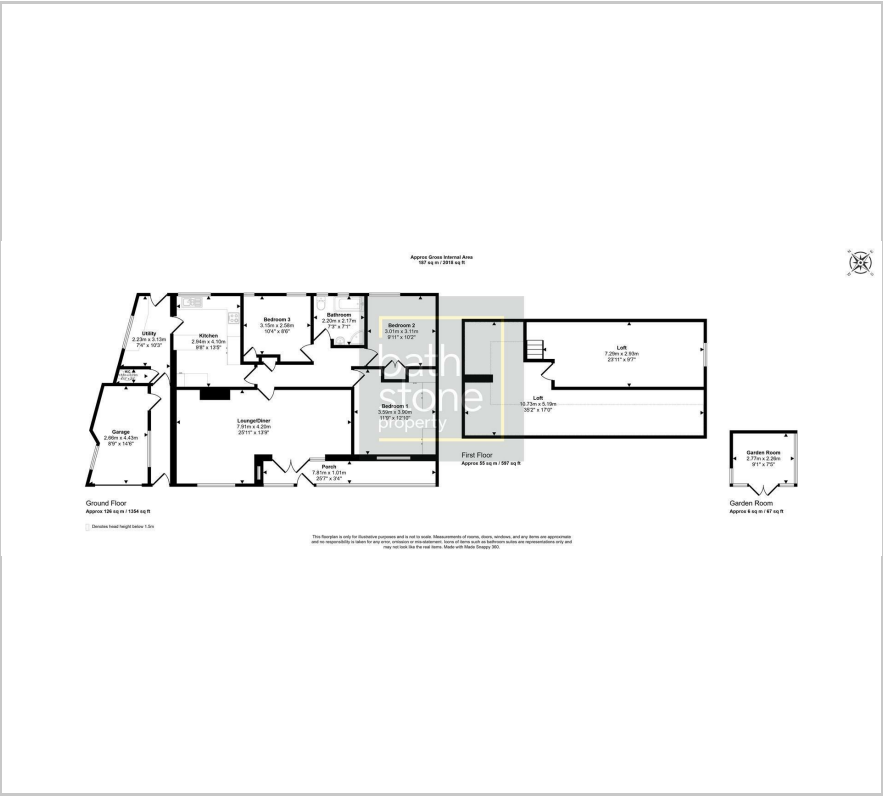

Energy Efficiency Graph

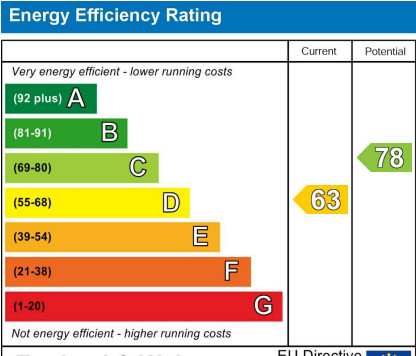

Give us some feedback



These particulars, whilst believed to be accurate are set out as a general outline only for guidance and do not constitute any part of an offer or contract. Intending purchasers should not rely on them as statements of representation of fact, but must satisfy themselves by inspection or otherwise as to their accuracy. No person in this firms employment has the authority to make or give any representation or warranty in respect of the property.